

# Folded Photo Wreath

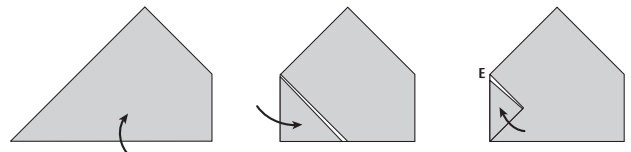

8. Fold corner D to A.

9. Fold corner C to the center.

10. Next fold back corner C to E.

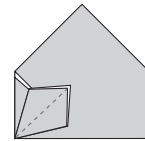
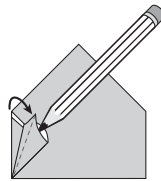

11. Insert a pencil into the last fold to create a pocket.

12. Flatten the pocket to form a small kite shape.

1. To create the photo wreath, cut 25 3"×3" squares (the size of a standard Post-it™ note) from any style of lightweight paper. Cut a few extra for practice.

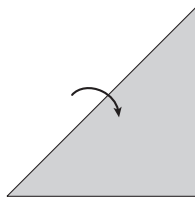
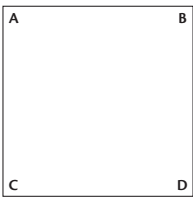

2. On the backside of your practice square, label the corners with a pencil.

3. Fold corner A to corner D and crease the diagonal edge.

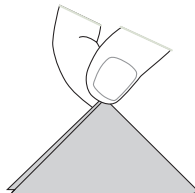
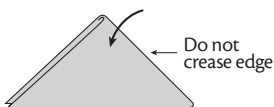

4. Fold corner B to C. Do not crease the edge.

5. Pinch top of triangle to create a center crease.

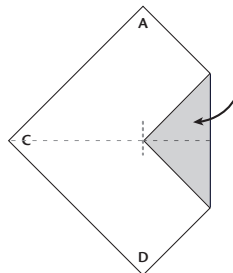
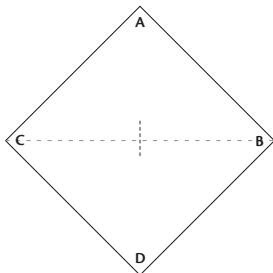

6. Unfold square. (The creases are guidelines for the next steps.)

7. Fold corner B to the center mark.

To assemble the folded squares into a wreath shape, first cut a circle with an outer diameter of 7" and a center diameter of 5" (measurements will vary depending on the size of your photograph). Use this ring as a guide during assembly. Begin with one folded square, "kite"-side up, point-side out. Attach a piece of double-sided tape to the front. Layer on the next piece by touching the bottom point of the kite to the right point of the previous kite as shown below. Repeat all the way around the ring. Tuck last piece under the first.

